

# LIGHTLIFT 14.72 TTS

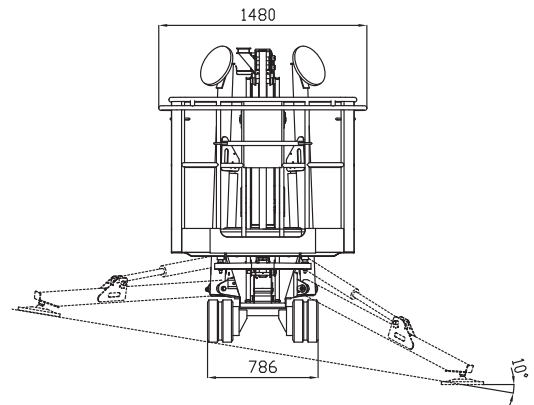

# LIGHTLIFT 14.72 III S

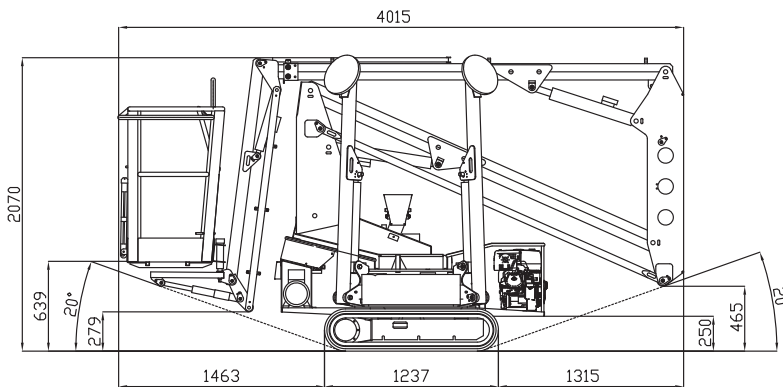
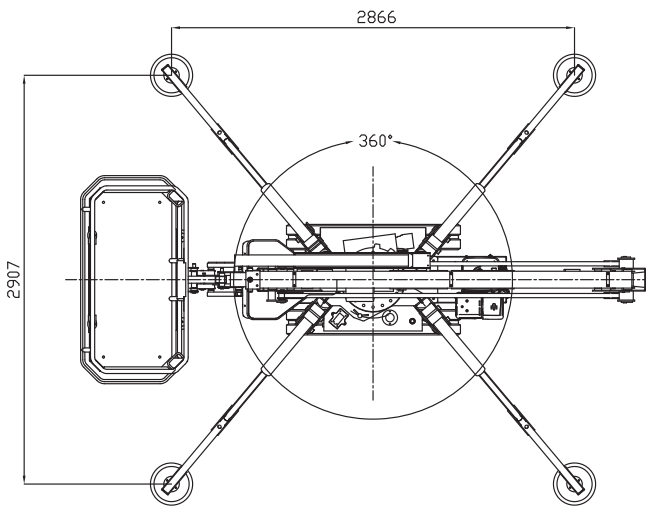
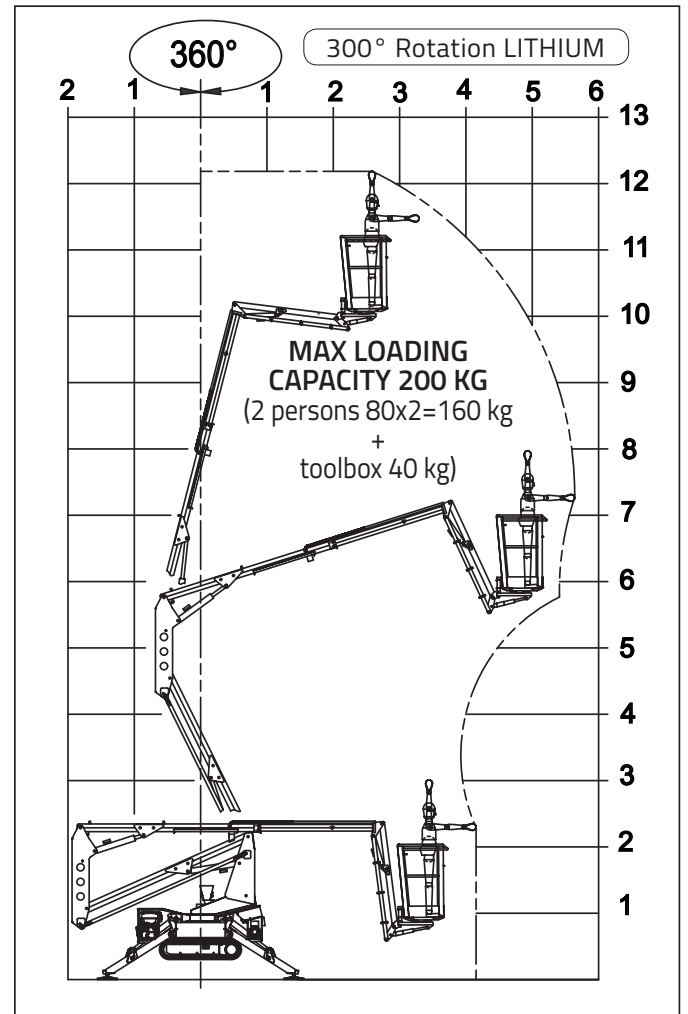
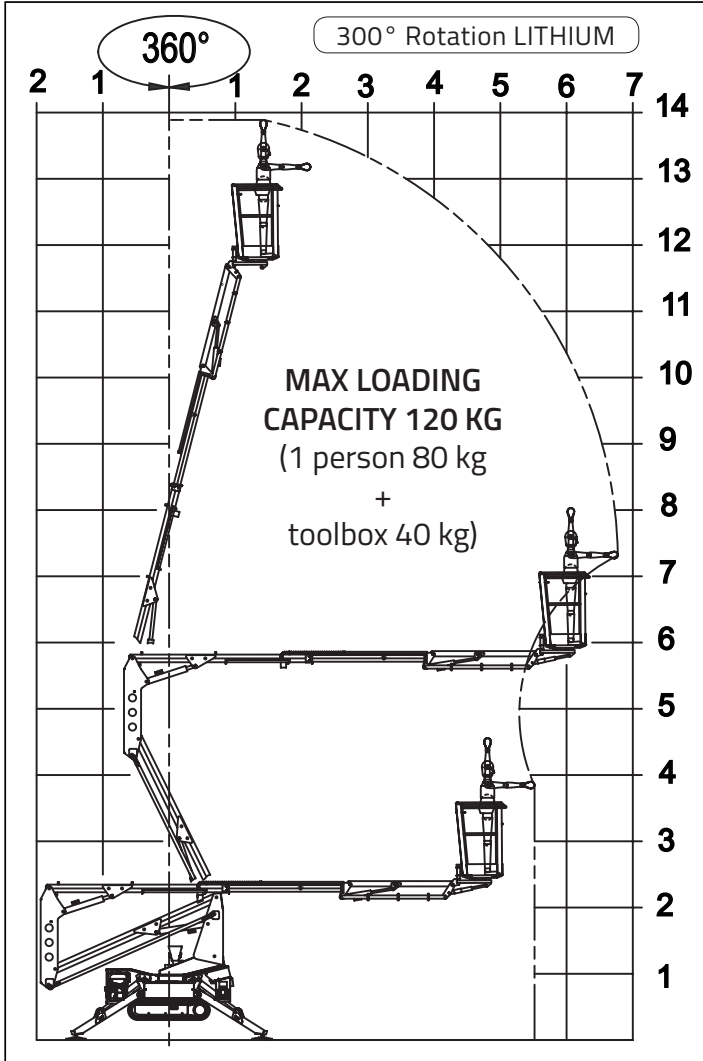

# LIGHTLIFT 14.72 III S

## PETROL ENGINE

Brand..... HONDA  
 Type ..... GX270 / GX390  
 Pistons no. and displacement ..... single-cylinder 270 cm<sup>3</sup> / 389 cm<sup>3</sup>  
 Max gross power ..... 8,4 HP - 6,3 kW / 11,7HP - 8,7 kW @ 3600 rpm  
 Electrical start ..... 12 volt

## DIESEL ENGINE

Brand ..... HATZ  
 Type ..... 1B30 - HD Autorev  
 Pistons no. and displacement..... single-cylinder 347 cm<sup>3</sup>  
 Potenza lorda max. .... 7,3 HP - 5,4 kW @ 3600 rpm  
 Electrical start ..... 12 volt

## ELECTRIC MOTOR

Standard ..... 230V / 50 Hz - 2,2 kW  
 Optional ..... 110V / 50 Hz - 2,2 kW

## HYDRAULIC PUMPS

Pump diesel engine ..... no. 2 gear pumps  
 Pump electric motor ..... no. 2 gear pumps

## TRACKED UNDERCARRIAGE

Track tensioner ..... grease-filled  
 Rollers no. per side ..... 3 + slide  
 Fixed width ..... 786 mm  
 Translation speed (Petrol engine) ..... 1,3 km/h  
 Translation speed with optional 2<sup>nd</sup> speed (Petrol engine) ..... 1,3 - 2,6 km/h  
 Translation speed (Diesel engine) ..... 1,5 km/h  
 Translation speed with optional 2<sup>nd</sup> speed (Diesel engine) ..... 1,5 - 3 km/h

WEIGHT MACHINE (Petrol / Diesel engine) ..... 1398 kg  
 MAX UPPER SLANT ..... 16° / 28,7%  
 MAX WIND SPEED ..... 12,5 m/s

# LIGHTLIFT 14.72 III



## ELECTRIC SYSTEM - LITHIUM ION

Electric system voltage.....	48V-12V
Lithium battery pack .....	4,8 kWh
Autonomy (continuous cycle)* .....	4-5 h
Onboard battery charger .....	220V 50Hz
Optional battery charger .....	110V 50Hz
Recharge time on flat batteries .....	4 h (indicative)
Recharge time to 80% on flat batteries .....	2 h (indicative)

## HYDRAULIC PUMPS

Electric motor .....	no.2 gear pumps
----------------------	-----------------

## TRACKED UNDERCARRIAGE

Track tensioner .....	grease-filled
Rollers no. per side.....	3 + slide
Fixed width .....	786 mm
Translation speed .....	1,1 km/h
Translation speed with standard 2 <sup>nd</sup> speed .....	1,1 - 2,1 km/h

WEIGHT MACHINE .....	1490 kg
MAX UPPER SLANT .....	16° / 28,7%
MAX WIND SPEED .....	12,5 m/s

\* (Autonomy measured with Hinowa H2 operating cycle)