

LL33.17

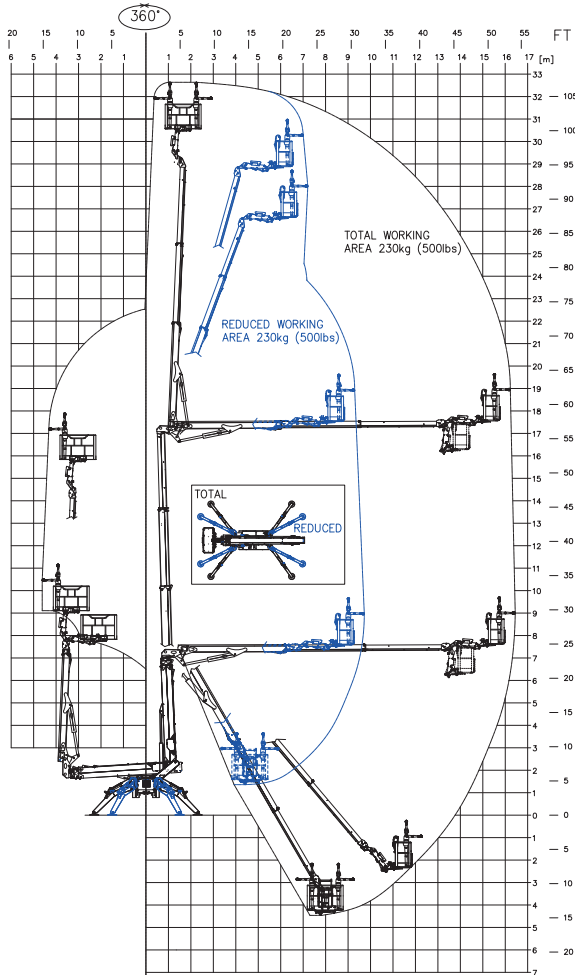

**CAPACITY 230 kg**  
(2 persons 80x2=160 kg + tool box 70 kg)

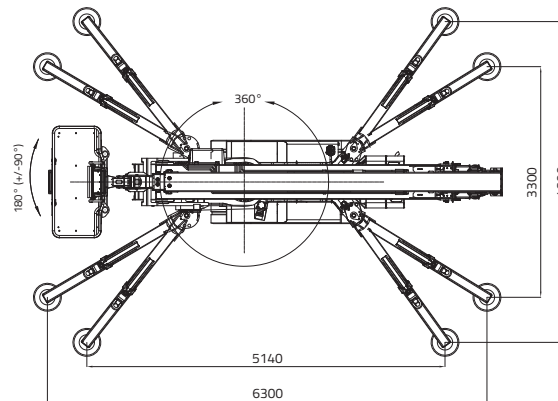
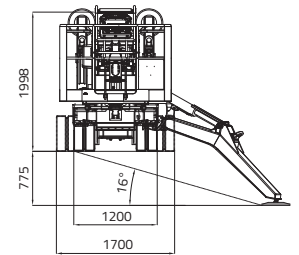
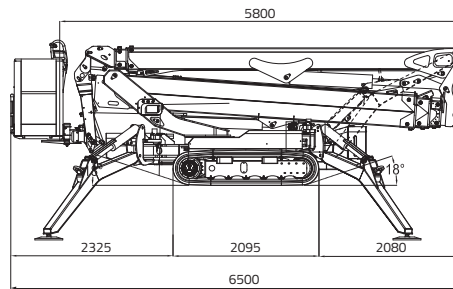

 32,60 m

 16,50 m

 6,50 m

 5,80 m

 1,99 m

 1.600 x 700 x h. 1.100 mm

 180° (+/-90°)

 16° / 28,7%

 1.200 / 1.700 mm

 5.000 daN - 4 daN/cm<sup>2</sup>

 Wide stabilization area  
4.600 x 5.140 mm  
Narrow stabilization area  
3.300 x 6.300 mm

 Automatic set up system IIIS std

 Remote control

 GPRS-GPS

 R.A.H.M.

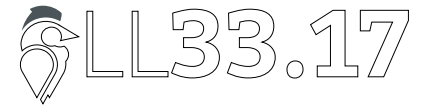

**DIESEL ENGINE**

Brand .....KUBOTA  
Type .....D902 Autorev  
Pistons no. and displacement..... 898 cm<sup>3</sup>  
Max. gross power .....  
..... 21,6 HP - 16,1 kW @3200rpm  
Electrical start..... 12 volt

**LITHIUM-ION ENGINE**

Battery ..... 150 Ah  
Electric motor:  
- rated voltage..... 76 V  
- rated power ..... 3,5 kW  
Onboard battery charger.... 110V-230V+-30V 50-60 Hz  
Autonomy (continuous cycle)\* ..... 4-5 h  
Recharge time on flat batteries .....  
..... 4 h (indicative)  
Recharge time to 80% on flat batteries.....  
..... 2 h (indicative)  
\* (Autonomy measured with Hinowa H1 operating cycle)

**HYDRAULIC PUMPS**

Electric motor ..... no.2 gear pumps

**TRACKED UNDERCARRIAGE**

Track tensioner ..... grease-filled  
Rollers no. per side ..... 6 + slide  
Widening system..... 1200 / 1700 mm  
Translation speed with 2<sup>nd</sup> auto2speed:  
- diesel engine ..... 0,8 - 1,8 km/h  
- lithium-ion engine ..... 0,6 - 1,3 km/h

WEIGHT MACHINE ..... 7860 kg  
MAX UPPER SLANT ..... 16° / 28,7 %  
MAX WIND SPEED ..... 12,5 m/s